

AUDI

1997-2002 A4 & A4 Quattro

PRECAUTIONS

Warning: Acid has strong corrosive properties. If batteries are handled inappropriately, there is a risk that personal injury may result from exposure to harmful electrolyte influences.

Warning: If electrolyte drips out from battery, skin can be burned by acid, and vehicle may be affected by acid erosion and corrosion. It is a possibility that safety-related vehicle components can be damaged.

Warning: The gas resulting from charging and partially after charging is explosive. In extreme cases, if battery is handled inappropriately, the emitted gases may cause the battery to explode.

Warning: Danger of personal injury when engine starts automatically. When Start/Stop System is activated (indicator lamp in instrument cluster is on), the engine can start up automatically. Always ensure Start/Stop System is deactivated whenever working on vehicle. Switch off ignition.

Caution: Only perform battery procedures in suitable and well-ventilated locations.

Note: The ABS lamp may be illumi-

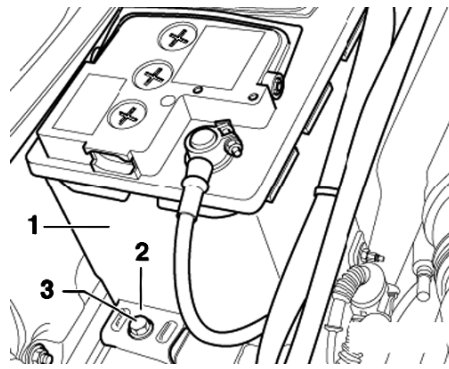

Fig. 1 Battery removal

nated after reconnecting battery, but will go out after vehicle is driven a short period.

BATTERY Removal

1. Record radio station presets.
2. Turn off all lamps and accessories.
3. Turn ignition switch to OFF position.
4. Disconnect battery ground cable from battery ground terminal.

5. Disconnect battery positive cable from battery positive terminal.
6. Remove battery hold down bolt (3), Fig. 1.
7. Remove battery hold down bracket (2), Fig. 1.
8. Disconnect gas vent hose.
9. Lift battery (1) out of battery tray, Fig. 1.

Installation

1. Install battery and ensure it is fully seated in tray.
2. Connect gas vent hose.
3. Install battery hold down bracket (2), and torque bolt (3) to 11 ft. lbs., Fig. 1.
4. Connect battery positive cable from battery positive terminal, and torque clamp bolt to 53 inch lbs.
5. Connect battery ground cable from battery ground terminal, and torque clamp bolt to 53 inch lbs.
6. Activate power window regulator one-touch up/down function. Refer to owner's manual for more information.
7. Synchronize remote control. Refer to owner's manual for more information.
8. Inspect any affected system or component such as clock, comfort adjustment, or compass for proper settings, and adjust as required.

The material herein may not be used without the prior express written permission of the copyright holder, including, but not limited to reproduction or transmission in any form by any means such as electronic, mechanical, photocopying, recording or otherwise; nor may it be stored on any retrieval system of any nature.

"The data reported herein has been compiled from authoritative sources. While every effort is made by the analysts to attain accuracy, manufacturing changes as well as typographical errors and omissions may occur on occasion. The publisher cannot be responsible nor does it assume any responsibility whatsoever for such omissions, errors or changes."

"Portions of materials contained herein have been reprinted under license from Volkswagen of America, Inc., License Agreement 08500VWA."

MOTOR INFORMATION SYSTEMS
MOTOR is a trademark of Hearst Business Media
A Unit of Hearst Corporation
1301 W. Long Lake, Suite 300
Troy, MI 48098

Copyright © 2012 Hearst Business Media. All rights reserved.