

CHEVROLET

2014 Impala Limited

PRECAUTIONS

Warning: Batteries produce explosive gases, contain corrosive acid, and supply levels of electrical current high enough to cause burns. Therefore, to reduce the risk of personal injury when working near a battery: Always shield your eyes and avoid leaning over the battery whenever possible; do not expose the battery to open flames or sparks; do not allow the battery electrolyte to contact the eyes or skin; flush immediately and thoroughly any contacted areas with water, and get medical help.

BATTERY Removal

Caution: Use the correct fastener in the correct location. Replacement fasteners must be the correct part number for that application. Do not use paints, lubricants, or corrosion inhibitors on fasteners or fastener joint surfaces, unless specified. These coatings affect fastener torque and joint clamping force and may damage the fastener. Use the correct tightening sequence and specifications when installing fasteners in order to avoid damage to components and systems. When using fasteners that are threaded directly into plastic, use extreme care not to strip the mating plastic components. Use hand tools only, and do not use any kind of impact or power tools. Fastener should be hand tightened, fully seated, and not stripped.

Do not tip the battery more than 40° during removal.

1. Remove battery ground post clamp (1) from battery and position battery ground cable (2) aside, **Fig. 1**.
2. Remove electrical center cover (1), **Fig. 2**.
3. Disconnect positive battery cable from junction box.
4. Remove fasteners (1) securing electrical center board (2), **Fig. 3**.

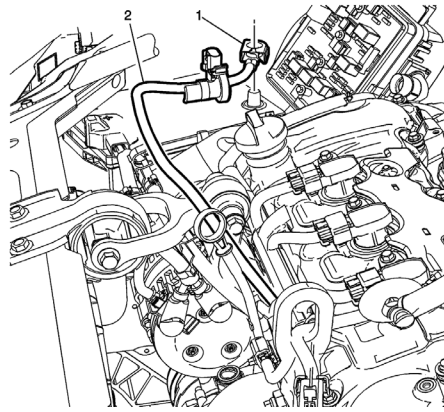

Fig. 1 Battery ground post clamp removal

5. Unlock tabs on electrical center board.
6. Lift up on electrical center board.
7. Remove fasteners (1) securing electrical center bracket (2) to vehicle, **Fig. 4**.
8. Remove righthand front diagonal brace.
9. Open positive battery cable terminal cover and release positive cable clamp (1), **Fig. 5**.
10. Remove positive battery cable from battery.
11. Remove battery hold down fastener (1) and hold down retainer (2), **Fig. 6**.
12. Remove battery (1) from vehicle, **Fig. 7**.
13. Remove battery insulator (1), **Fig. 8**.

Installation

Caution: Use the correct fastener in the correct location. Replacement fasteners must be the correct part number for that application. Do not use paints, lubricants, or corrosion inhibitors on fasteners or fastener joint surfaces, unless specified. These coatings affect fastener torque and joint clamping force and may damage the fastener. Use the correct tightening sequence and specifications when installing fasteners in order to avoid damage to components

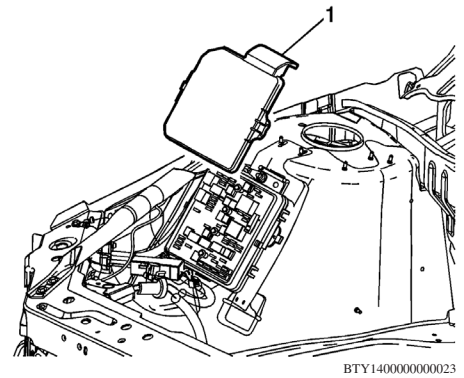

Fig. 2 Electrical center cover removal

and systems. When using fasteners that are threaded directly into plastic, use extreme care not to strip the mating plastic components. Use hand tools only, and do not use any kind of impact or power tools. Fastener should be hand tightened, fully seated, and not stripped.

Do not tip the battery more than 40° during installation.

1. Install battery insulator (1), **Fig. 8**.
2. Install battery (1) into vehicle, **Fig. 7**.
3. Install battery hold down retainer (2) and **torque** fastener (1) to 13 ft. lbs., **Fig. 6**.
4. Install positive battery cable clamp (1) to battery positive post and **torque** to 89 inch lbs., **Fig. 5**.
5. Install battery positive cover.
6. Install fasteners (1) securing electrical center bracket (2) to vehicle, **Fig. 4**. **Torque** fasteners to 86 inch lbs.
7. Install fasteners (1) securing electrical center board (2), **Fig. 3**. **Torque** fasteners to 62 inch lbs.
8. Connect positive battery cable to junction box.
9. Install electrical center cover (1), **Fig. 2**.
10. Install battery ground post clamp (1) to battery ground post and **torque** to 89 inch lbs., **Fig. 1**.
11. Install righthand front diagonal brace.

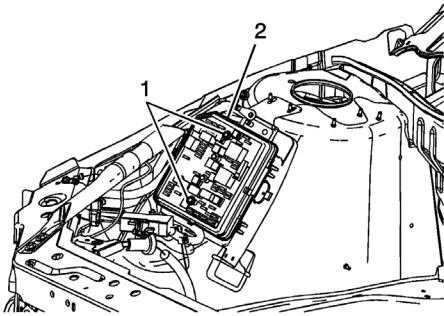

Fig. 3 Electrical center board fastener removal

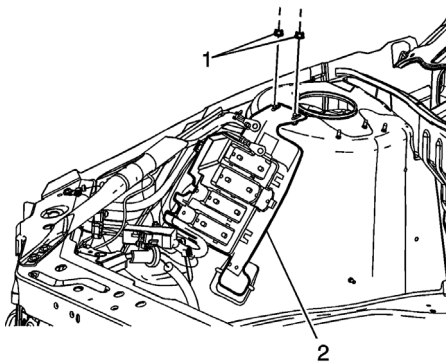

Fig. 4 Electrical center bracket fastener removal

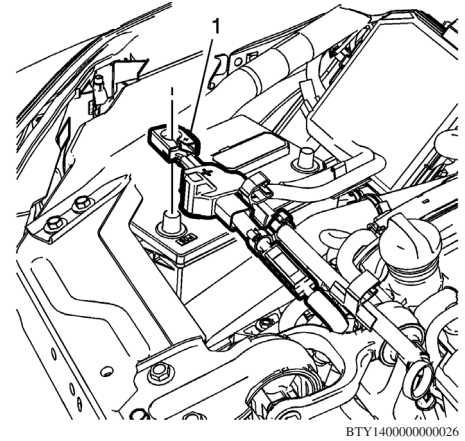

Fig. 5 Battery positive cable clamp release

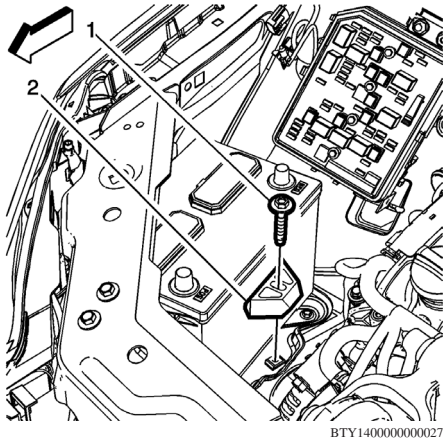

Fig. 6 Battery hold down retainer removal

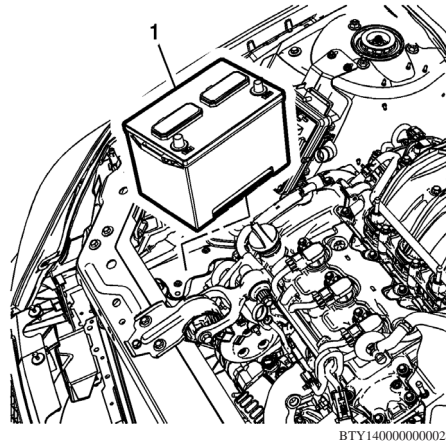

Fig. 7 Battery removal

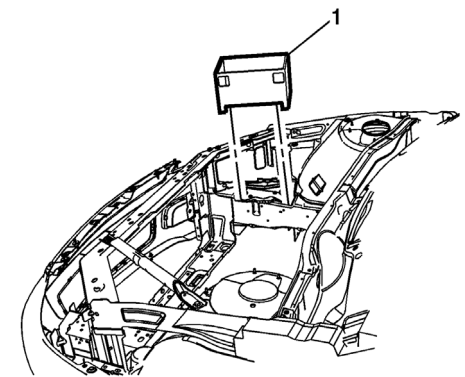

Fig. 8 Battery insulator removal

The material herein may not be used without the prior express written permission of the copyright holder, including, but not limited to reproduction or transmission in any form by any means such as electronic, mechanical, photocopying, recording or otherwise; nor may it be stored on any retrieval system of any nature.

"The data reported herein has been compiled from authoritative sources. While every effort is made by the analysts to attain accuracy, manufacturing changes as well as typographical errors and omissions may occur on occasion. The publisher cannot be responsible nor does it assume any responsibility whatsoever for such omissions, errors or changes."

"Portions of materials herein have been reprinted with permission of General Motors LLC, Customer Care and Aftersales, License Agreement 1110717."

MOTOR INFORMATION SYSTEMS
MOTOR is a trademark of Hearst Business Media
A Unit of Hearst Corporation
1301 W. Long Lake, Suite 300
Troy, MI 48098

Copyright © 2015 Hearst Business Media. All rights reserved.